

7 HOLES 13/16" DIA. FOR 3/4" DIA. BOLTS.

ALL DIMENSION ARE AS PER SECTION 'A-A'

FOR 6MM φ M.S. BAR STIRRUPS.

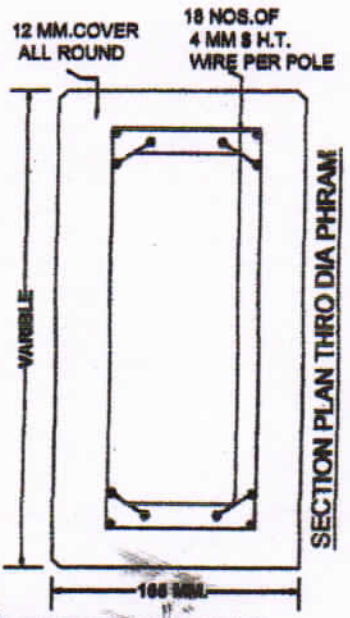
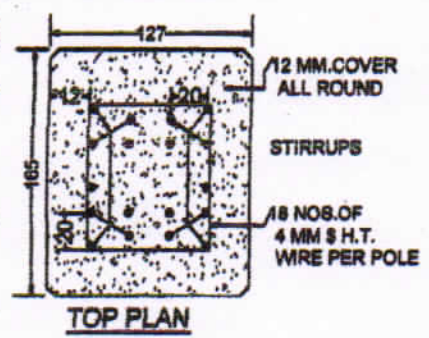

- NOTE:**
1. THE DIMENTION SHOWN ARE IN M.M.
 2. ALL STIRRUPS SHALL BE WELDED AT LAPS.
 3. APROXIMATE WEIGHT OF POLE 650 KG.
 4. BOTTOM & TOP OF P S C POLE SHALL BE PAINTED WITH ANTI CORROSIVE BLACK EPOXY BASE BITUM-NOUS PAINT.
 5. 6 MMS STIRRUPS 27 NOS.
 6. TENSION WIRE 4MM. H.T. STEEL 18 NOS.
 7. CONCRETE GRADE M - 45
 8. WORKING LOAD 270 KG.
 9. FACTOR OF SAFETY 2.5
 10. 4 MM. DIA. H.T. STEEL 12 NOS. SPIRAL.
 11. WEB THICKNESS 68 MM.
 12. VOLUME PER POLE - 0.289 CMT.

SR.NO.	NO. OF RING	RING SIZE	WINDOW SIZE	
			FROM BOTTOM (APPROX)	FROM BOTTOM
1.	3 Nos.	390 X 145	1. 270	X 480
2.	2 Nos.	355 X 145	2. 250	X 470
3.	3 Nos.	315 X 145	3. 270	X 480
4.	3 Nos.	290 X 145	4. 230	X 480
5.	2 Nos.	270 X 145	5. 190	X 780
6.	2 Nos.	250 X 145	6. 160	X 780
7.	2 Nos.	200 X 145	7. 125	X 780
8.	2 Nos.	170 X 145	8. 110	X 780
9.	3 Nos.	140 X 145	9. 85	X 780
10.	5 Nos.	110 X 145	10. 65	X 780
	27 Nos.			

PASCHIM GUJARAT VIJ COMPANY LIMITED
CORPORATE OFFICE
 Nana Maya Road, Laxminagar,
 RAJKOT - 360004.
CIN U40102GJ2003SGC042908
 Phone : (0281) 2380425 Fax : (0281) 2380428

DRAWING OF 10MT x 270 KG PSC POLE